

# GS-1276 (1:2.5K)

Counties: Kern  
Flight date(s): 08-01-1989  
Scale: 1:2,550  
Overlap: 60%

Complete Metadata:  
<https://www.library.ucsb.edu/src/airphotos/aerial-photography-information>

Note: Ridgecrest; Area between Drummond Avenue, North Norma Street, Inyokern Road, and South Knox Road.

FLIGHT LOCATION

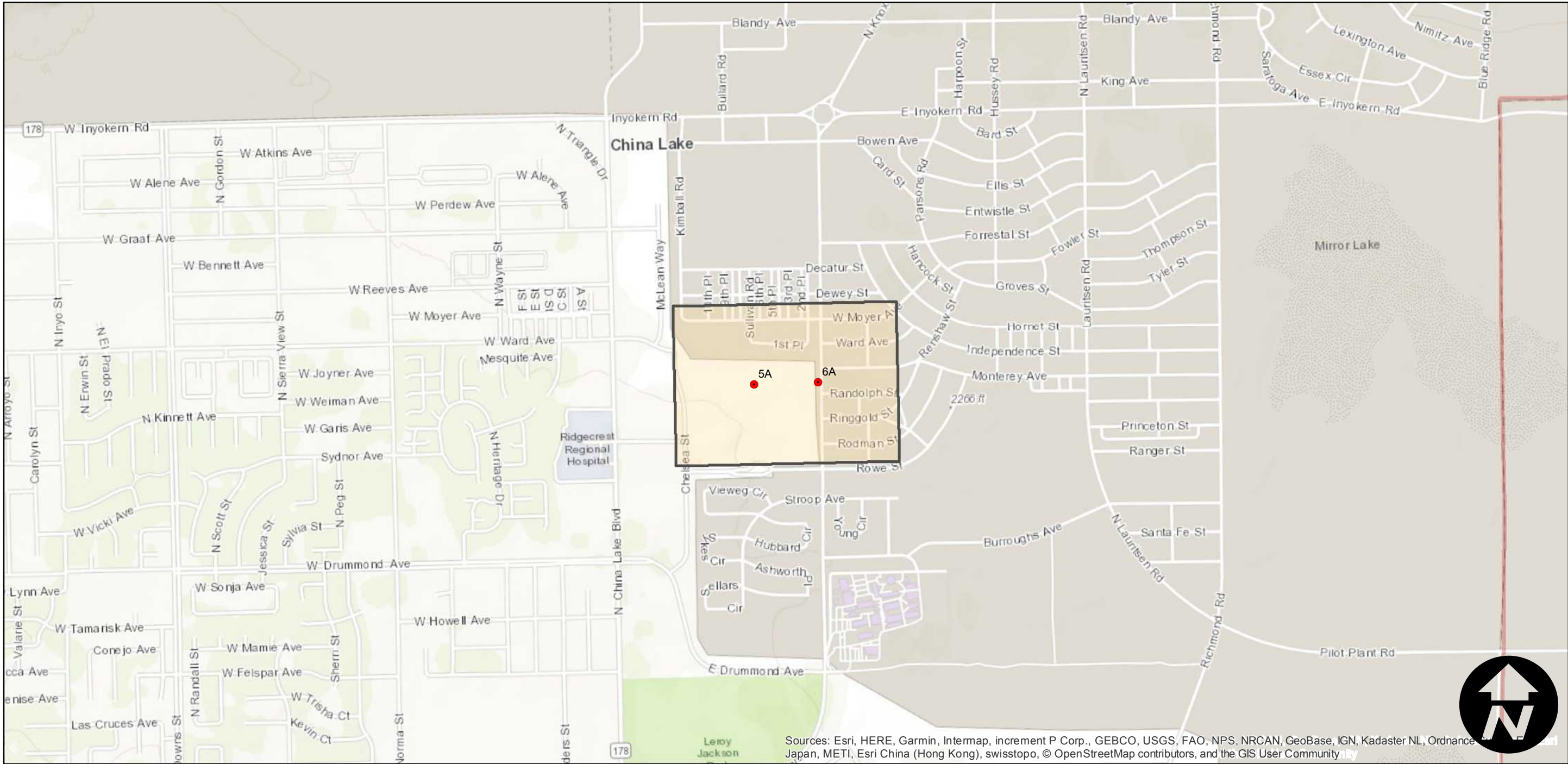
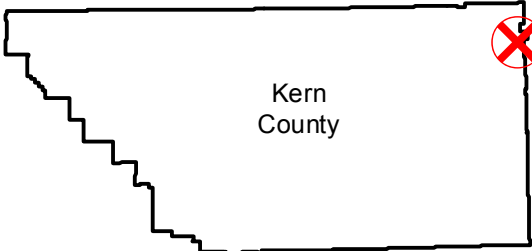

0 0.25 0.5 1 Miles

Index to Aerial Photography  
Page 1 of 1

Scale of this index: 1:15,000