

GS-1029 (1:3,200)

Counties: Santa Barbara
Flight date(s): 03-04-1988
Scale: 1:3,200
Overlap: 60%

Complete Metadata:
<https://www.library.ucsb.edu/src/airphotos/aerial-photography-information>

Note: Lompoc; Junction of CA-246 and CA-1.

FLIGHT LOCATION

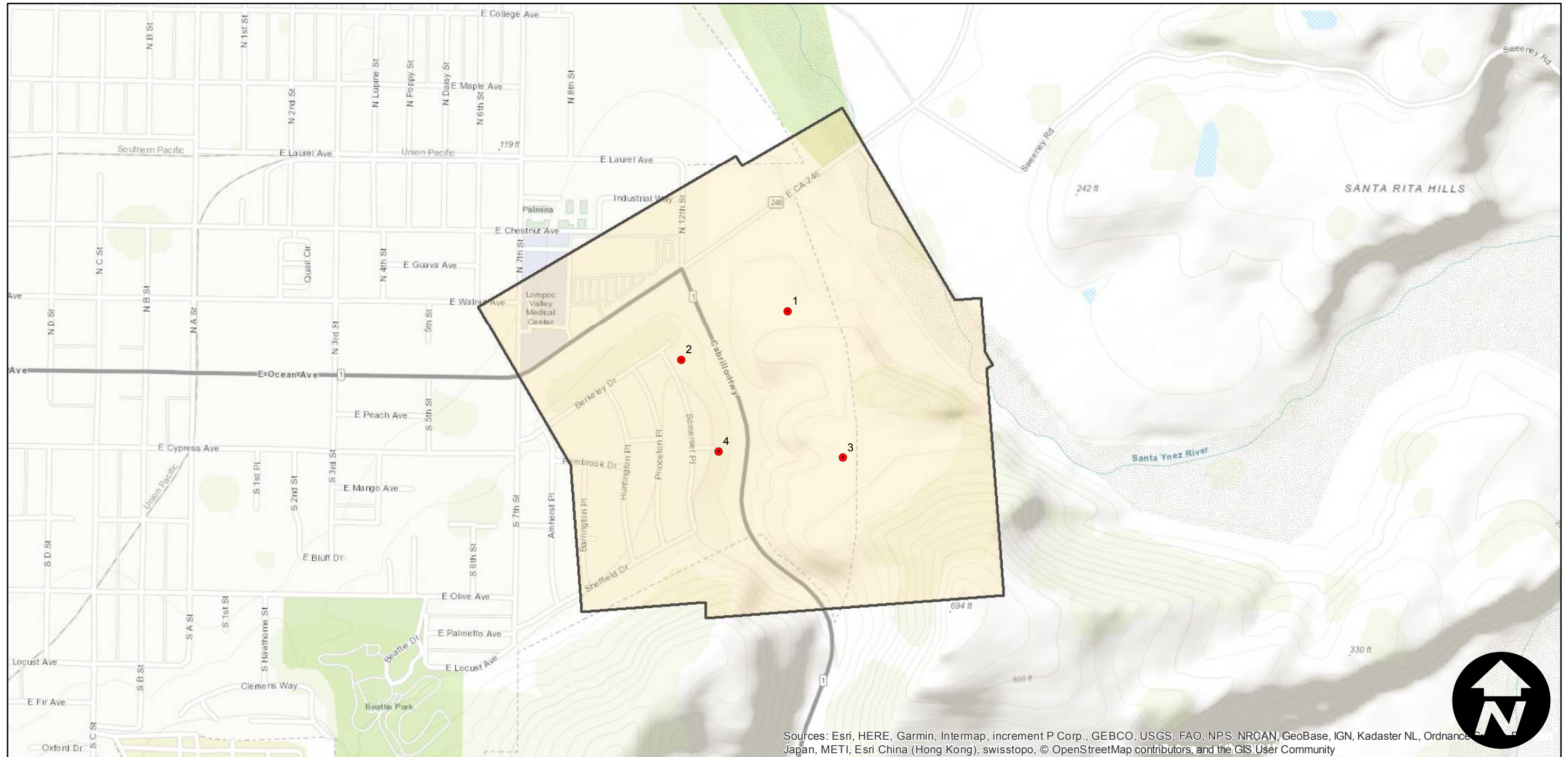
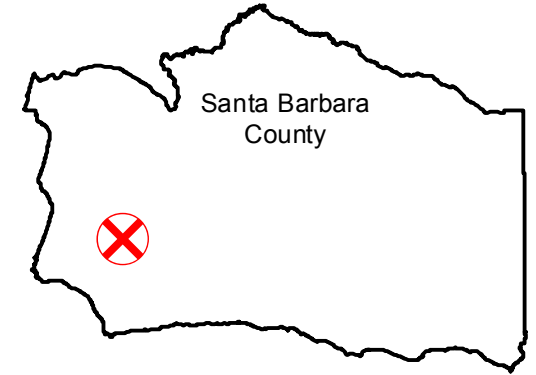

Sources: Esri, HERE, Garmin, Intermap, increment P Corp., GEBCO, USGS, FAO, NPS, NRCAN, GeoBase, IGN, Kadaster NL, Ordnance Survey, Esri China (Hong Kong), Swisstopo, © OpenStreetMap contributors, and the GIS User Community

0 0.15 0.3 0.6 Miles

Index to Aerial Photography
Page 1 of 1

Scale of this index: 1:10,000