

CAS-83251

Counties: Stanislaus
Flight date(s): 11-21-1983 to 12-20-1983
Scale: 1:4,200
Overlap: 60%

Complete Metadata:
<https://www.library.ucsb.edu/src/airphotos/aerial-photography-information>

Note: Vicinity west of Modesto city limits: Paradise Road from Riverdale Park to Illinois Avenue. Two sequences of photographs with same numbers, but taken on different dates and covering different locations. Imagery acquired October 2009.

FLIGHT LOCATION

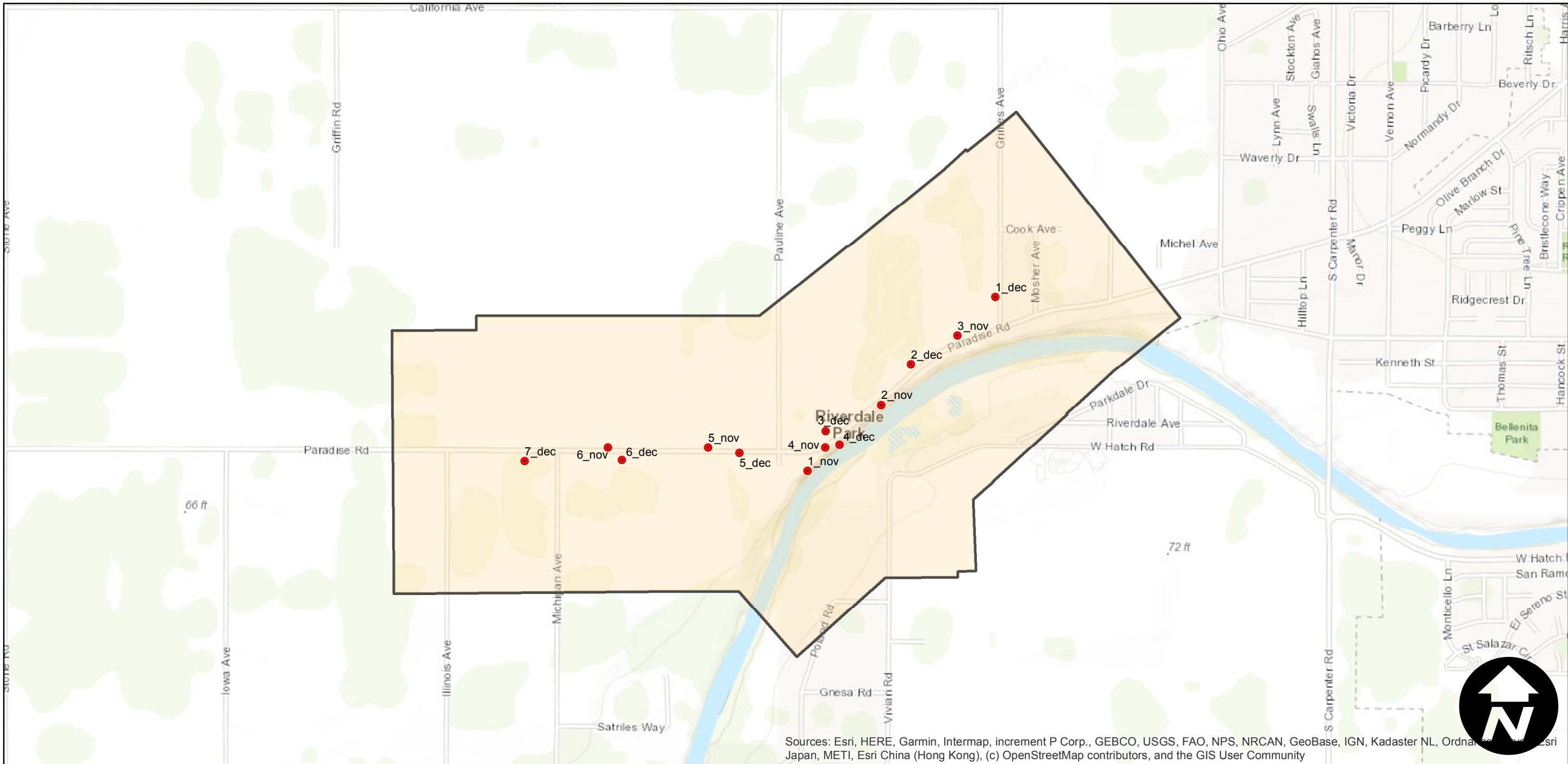
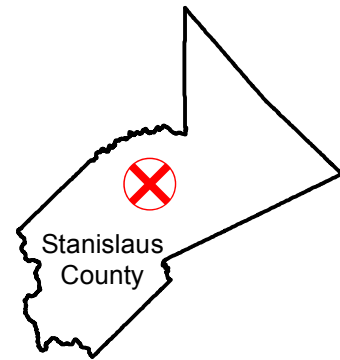

0 0.25 0.5 1 Miles

Index to Aerial Photography
Page 1 of 1

Scale of this index: 1:15,000